

FLOOR PLAN
SCALE: 1/32" = 1'-0"

NOTE:
(4) PALLET BARS
PER LEVEL.

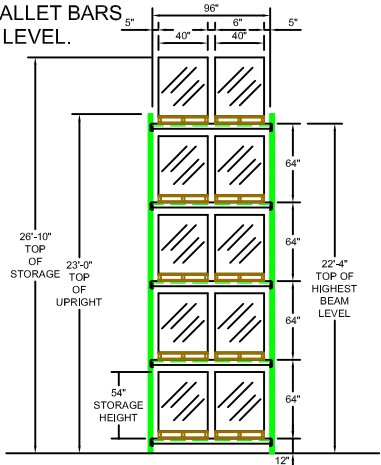

TYPICAL FRONT VIEW
SCALE: 1/4" = 1'-0"

Notes:

- 1.) THE RACK STRUCTURES HAVE BEEN DESIGNED IN ACCORDANCE WITH RMI (RACK MANUFACTURERS INSTITUTE) 2008 STANDARDS, IBC 2006, AND THE APPLICABLE PORTIONS OF THE ILLINOIS BUILDING CODE.
- 2.) ALL RACK COMPONENTS ARE TO BE MANUFACTURED BY UNARCO AND INSTALLED TO UNARCO SPECIFIED TOLERANCES FOR PLUMBNESS, LEVEL AND OUT-OF-SQUARE.
- 3.) ALL STEEL USED FOR THE RACK COMPONENTS IS TO BE ASTM A607-85 OR EQUIVALENT. MINIMUM YIELD FOR STEEL = 55 KSI
- 4.) ALL WELDS ARE TO BE PERFORMED TO AWS STANDARDS FOR SHOP WELDING. WELD ELECTRODES ARE TO BE E70XX.
- 5.) MAXIMUM PALLET WEIGHT = 2,500LBS. THIS CAPACITY IS BASED ON HEIGHT LEVELS SHOWN ON THE TYPICAL BAY ELEVATION. THE LEVELS OF STORAGE AS DIMENSIONED ON THE DRAWINGS ARE NOT TO BE CHANGED WITHOUT WRITTEN APPROVAL FROM INTEGRATED WAREHOUSE SYSTEMS, INC.
- 6.) CAPACITY SIGNS ARE TO BE INSTALLED IN PROMINENT LOCATIONS AS DETAILED BY RMI STANDARDS CAPACITIES ARE BASED ON UNIFORMLY DISTRIBUTED LOADS PER PAIR OF BEAMS.
- 7.) ESFR SPRINKLER SYSTEM INSTALLED IN BUILDING.
- 8.) STORED COMMODITY ARE NON ENCAPSULATED PALLETIZED FOOD.
- 9.) BUILDING CLEAR HEIGHT: 32'-0".
TOP OF STORAGE HEIGHT: 27'-6".
- 10.) ALL UPRIGHTS WILL HAVE (2) 3-3/4" x 1/2" CONCRETE ANCHORS SECURING EACH UPRIGHT. RMI DIRECTIVE.

INSTALLERS NOTES:

1. END FRAMES = 28FT HIGH W/ NO BULL NOSE
2. BACK FRAMES = 23FT HIGH W/ NO BULL NOSE
3. INTERMEDIATE FRAMES = 23FT HIGH W/ BULL NOSE
FRAMES CLOSEST TO TUNNEL WILL NOT REQUIRE BULL NOSE.
4. ROW SPACERS: PLACE (4) AT ROW ENDS & (3) AT INTERMEDIATES.
REFER TO FLOOR PLAN FOR EACH SPACER LENGTH & LOCATION.
5. ANCHORS: (2) 1/2" x 3-3/4" ANCHORS PER FOOT PLATE.

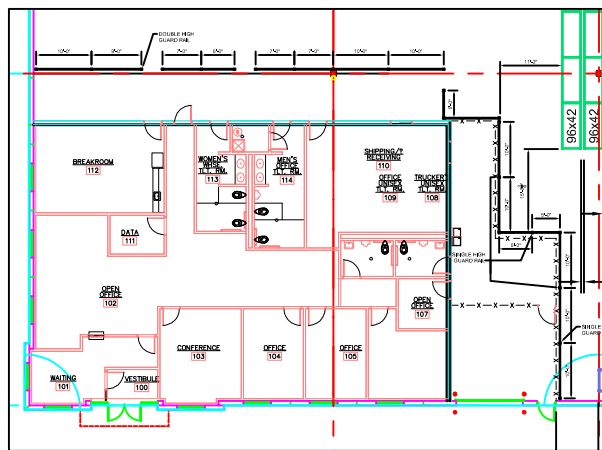

OFFICE BUILD OUT
SCALE: 3/32" = 1'-0"

R	JC	6-16-2006	ADD OFFICE AND PERCHING PER CUSTOMER REQUEST
A	JC	6-07-2006	MODIFIED LAYOUT W/ 10'-6" AISLES & PLACED BULK STORAGE
Customer:			
CUSTOMER			
LOCATION:			
LOCATION:			
TITLE:			
SCALE:	DRAWN:	DATE:	PROJECT:
DATE:	BY:	DATE:	PROJECT:



Integrated Warehouse Systems, Inc.

This drawing & all its information are the property of Integrated Warehouse Systems, Inc. Do not use, copy, or reproduce without the written consent of Integrated Warehouse Systems, Inc. Drawing to be returned upon demand.